

Monster Drop - Removing the Ball Drop Tray Assembly

Located in the top half of the cabinet, above the playfield, at the back of the cabinet.

1.



Make sure that the game is switched OFF. Use a flat screw driver to move the yellow retainer clip anti-clockwise to release.

2.

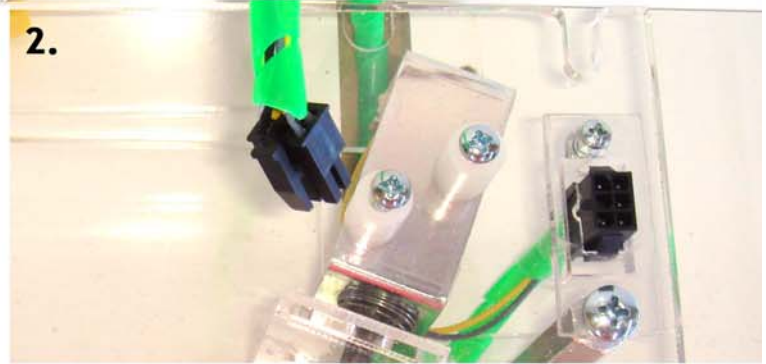

Unplug the 6 way connector, shown here with black plug and green cable.

3.

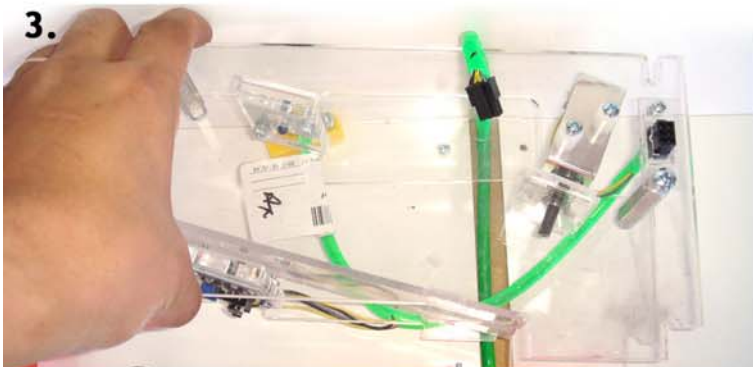

Lift the ball drop tray upwards to release from the tube below before bringing forwards.

4.

Follow the enclosed instructions for replacing the roll down tray perspex. When complete follow steps 3, 2 & 1 of these instructions in reverse to re-insert and re-attach the assembly.

5.

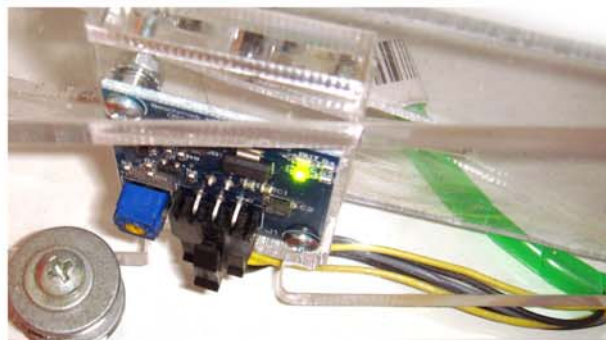

When the machine is turned on the sensor LED will light up to indicate that it has been re-attached and working.

Monster Drop - Ball Drop Tray Upgrade Instructions



Remove Ball Drop Tray from machine.

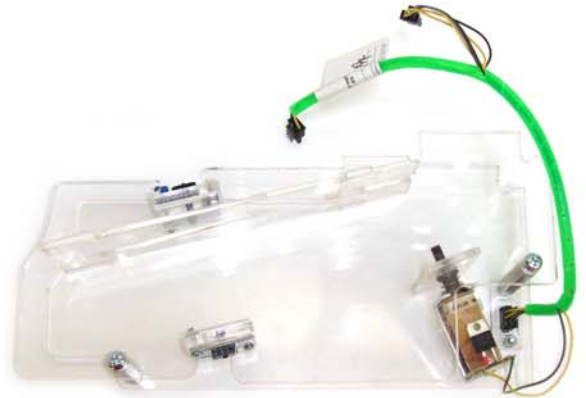

Disconnect wires from unit as shown above.

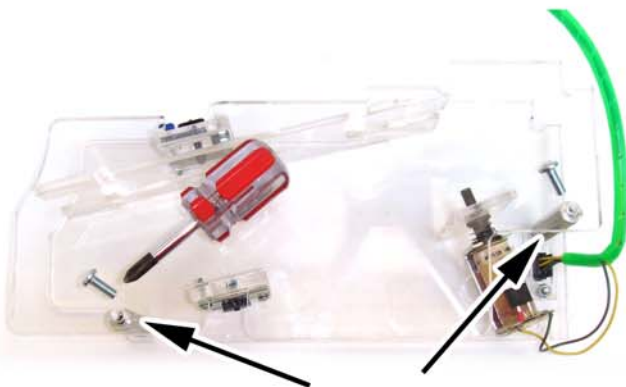

Remove two screws and remove perspex.

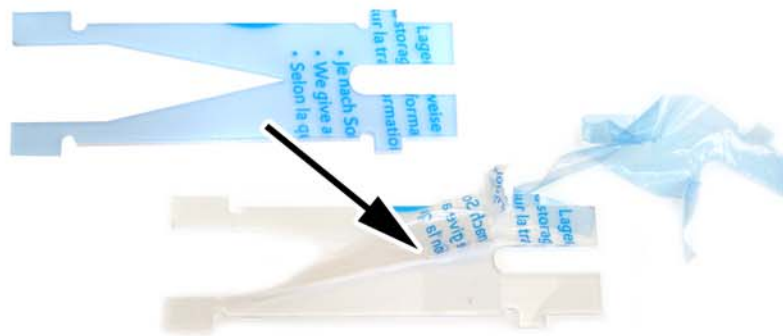

Remove protective cover from new part before installing.

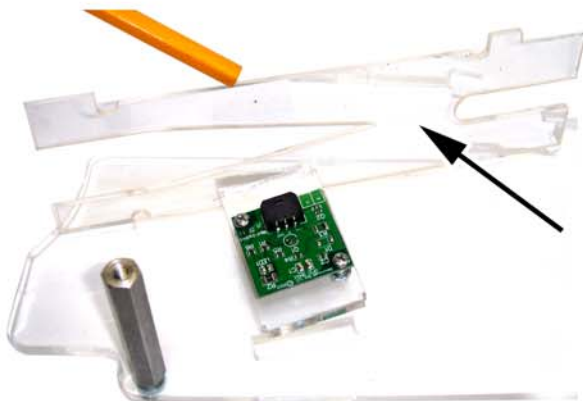

Replace part indicated with upgrade part enclosed.



Replace perspex, replace screws and reattach cables.

Installation of new Ball Run Down & Ball Receiver Tray - Page 1 of 2

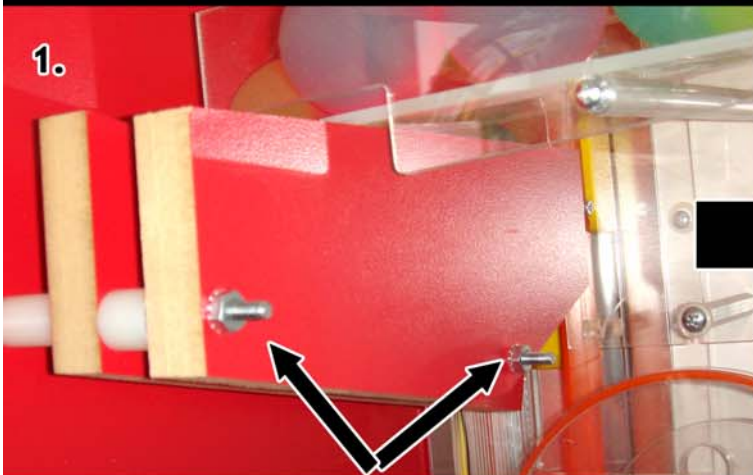

Inside the door, on the left side of the cabinet, unscrew the two UNC nuts which keep the red wooden parts in place.



Remove these components. Only the nuts need to be retained hold to the replacement component in place.

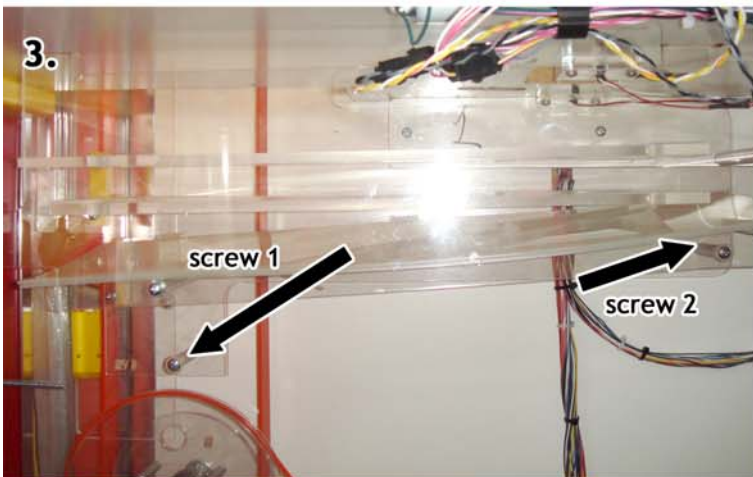

To remove the Ball Receiver Tray Assembly unscrew the two screws under neath...

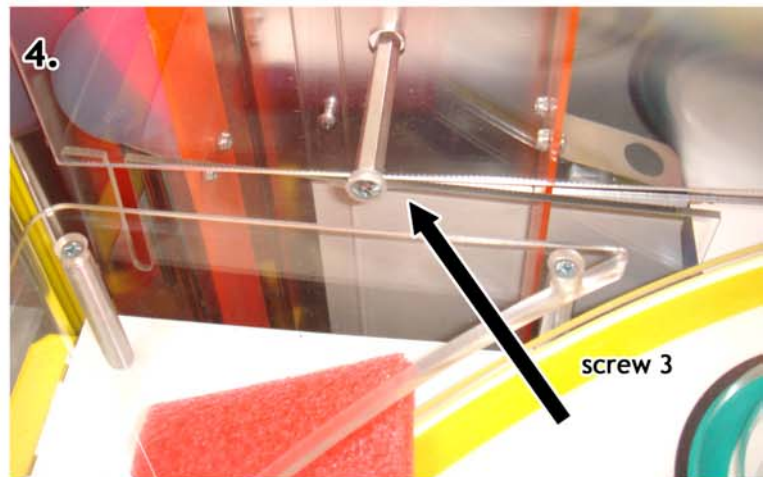

...and the third screw is at the top, shown here at the back of the playfield area.



Remove the Ball Reciever Tray and refer to upgrade instructions for this part. When complete reinstall...

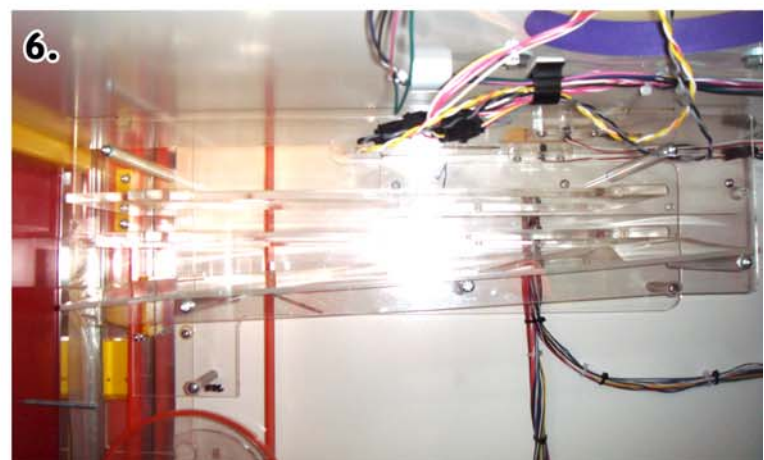

Insert the upgraded Ball Receiver Tray and secure in place with three screws removed in steps 3 & 4.

Installation of new Ball Run Down & Ball Receiver Tray - Page 2 of 2

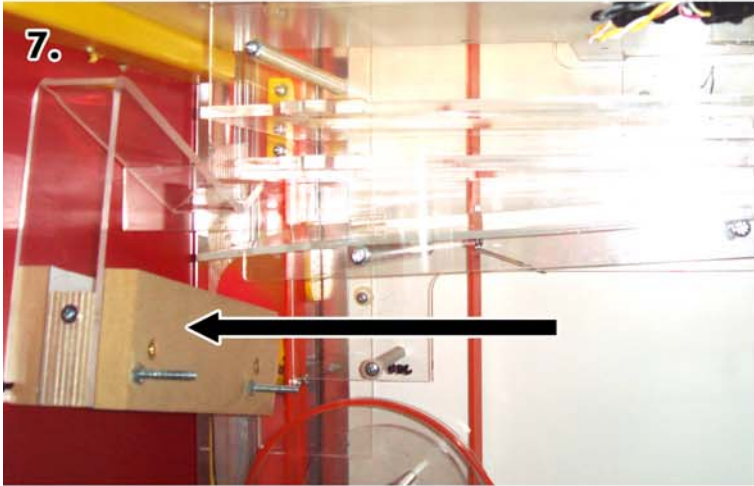

7. Install the provided replacement Ball Run Down. The upper cover should be on top as shown in the next step.

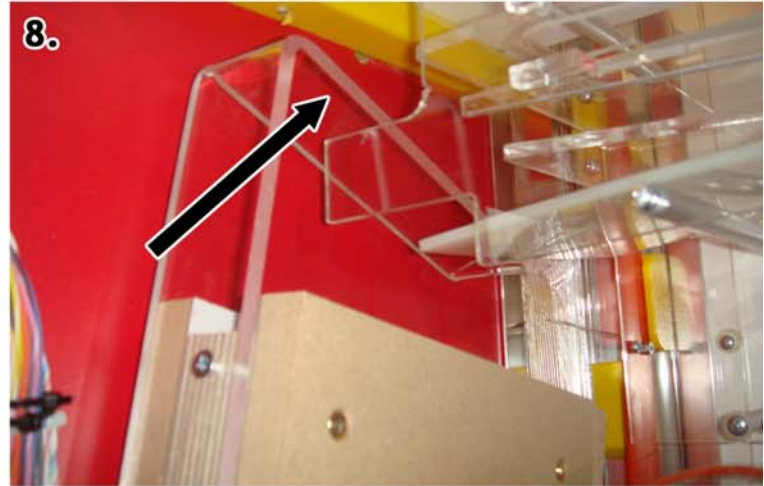

8. Secure new Ball Run Down with the nuts removed previously. Ensure that they are tight.

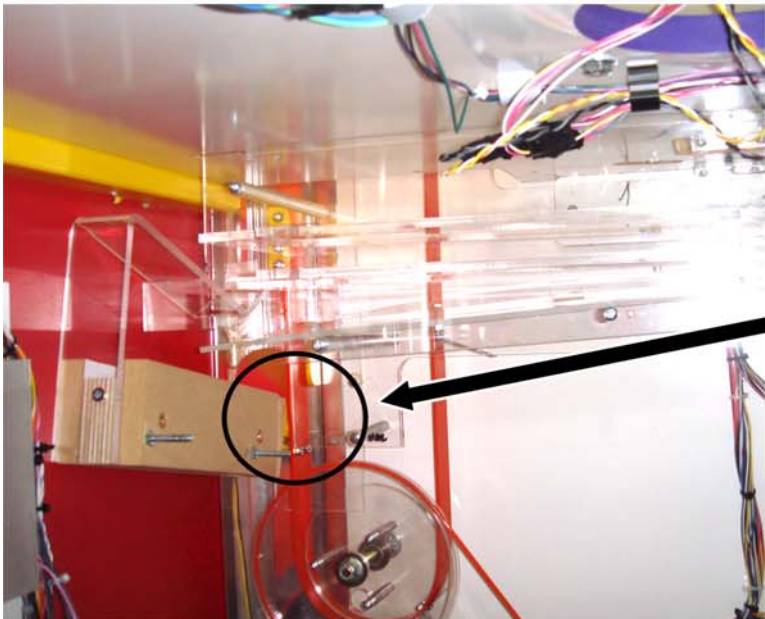

Revisit installation making note of the following points:

Ball run down should sit flush with the wall of the cabinet.

Tip of the ball rundown is aligned with the yellow spacer, circled in this picture.

Run a single ball starting from the turnable leaving it to run until it reaches the bottom. Ensure that it runs freely without catching.

Upgrade Receiver Tray (Page 1 of 2)

1.



Upgrade kit consists of:
 1pc Rod with 2x M4 Screws
 1pc M4 Screw / 1pc Serrated Washer
 1pc M4 Nut
 1pc modified rear plate.

2.

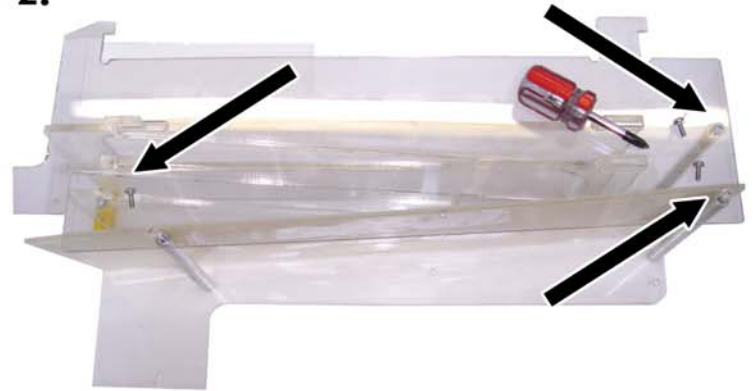

The the yellow block at the bottom remove 3 screws indicated by the arrows.

3.



Lift the 2x thin Front Plates perspex plates off. These are the ones without the yellow belt guide rail attached.

4.



Remove the opaque bottom plates and the centre and top clear plates. This leaves you with rear plate with yellow belt guide rail and 3 posts.

5.



NOTE:
 REAR PLATE WITH SLOTS HERE CAN BE DISCARDED ONCE ALL FITTINGS REMOVED.

Remove the screws and the yellow belt guide rail and the remaining posts. This rear plate can be discarded.

6.

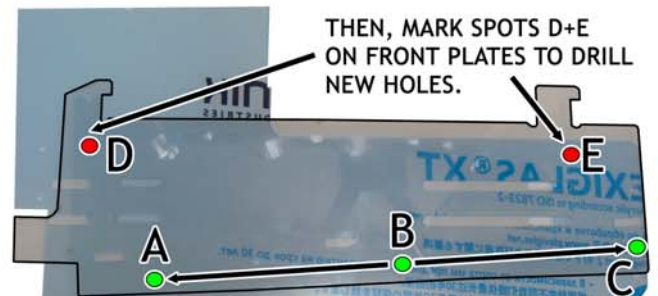

THEN, MARK SPOTS D+E ON FRONT PLATES TO DRILL NEW HOLES.

WITH THE NEW REAR PLATE ON TOP OF THE FRONT PLATES, ALIGN HOLES A+B+C FOR ALL LAYERS.

Align holes A+B+C on both new rear plate and front plate. Mark holes D+E on rear plate. Do this for each of the two thin front plates.

Upgrade Receiver Tray (Page 2 of 2)

7.

DRILL HOLES D+E MARKED ON TO EACH THIN FRONT PLATE WITH M4 DRILL BIT.

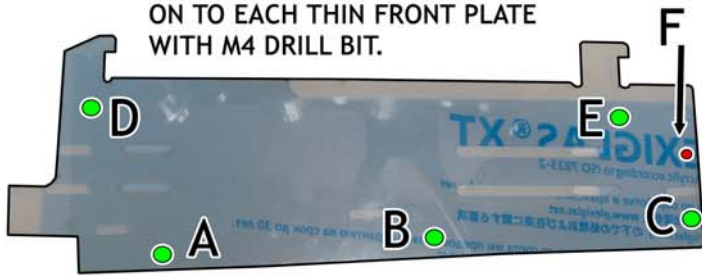

WHEN DONE ENSURE HOLES A+B+C+D+E ALL ALIGN WITH REAR PLATE.

8.

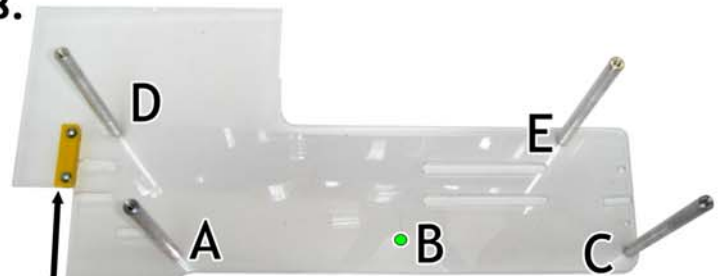

ATTACH YELLOW BELT GUIDE RAIL TO THE BACK OF THE REAR PLATE. SCREWS GO ON SAME SIDE AS POSTS.

Note position of hole F. This is no longer used. The post previously in this position now moves to hole E. The new pole included in the kit is inserted into hole D.

Attach posts into holes A, C, D and E of Rear Plate and attach with M4 screws. Then screw the yellow belt guide rail to the back of the rear plate.

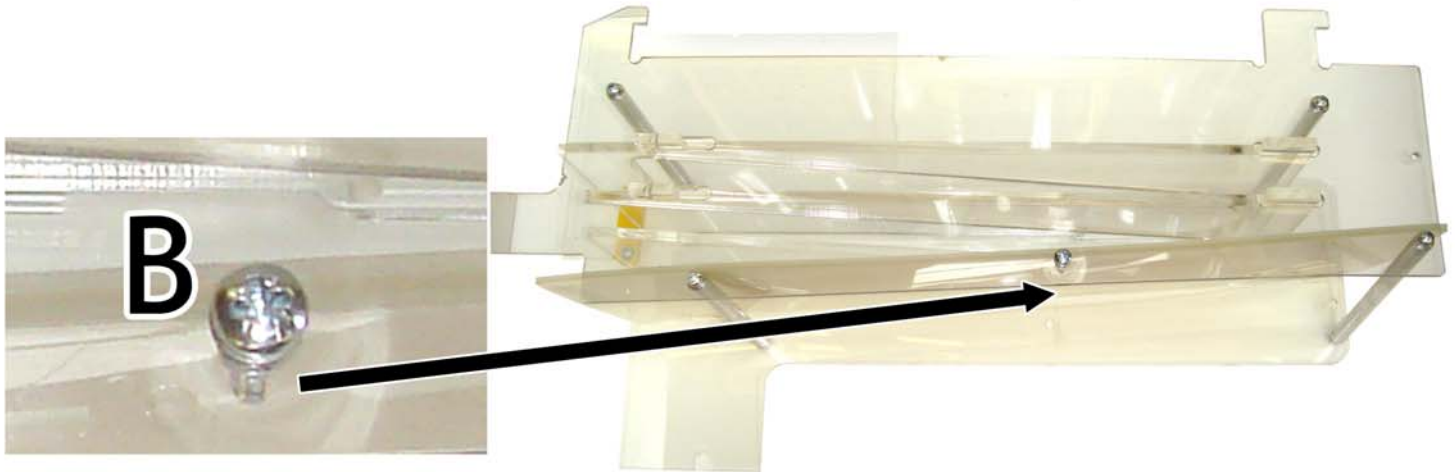

9. Insert M4 screw into Hole B and screw into place with the serrated washer and nut supplied.
10. Then re-install clear ball runs and the two opaque ball runs on the bottom level.
11. Install the two thin front plates (with the newly drilled holes) so that the posts are screwed into holes A, C, D & E with the M4 screws.
12. Refer to removal/installation notes for the Ball Drop Tray assembly to reinstall the upgraded unit back into the machine cabinet under the playfield.